

# cooksy®

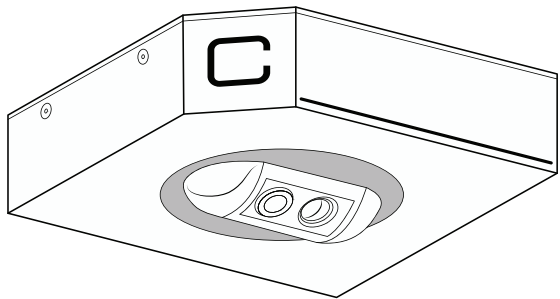

Instruction Manual

QR Code Instructions

<b>Watch the video</b>	<b>03</b>
<b>Hardware</b>	
<b>Content of Box</b>	<b>04</b>
<b>Accessories</b>	<b>05</b>
<b>Installation Options</b>	
<b>Options</b>	<b>06</b>
<b>Important General Requirements</b>	<b>07</b>
<b>Wall</b>	<b>08</b>
<b>Inset or Pullout</b>	<b>09</b>
<b>Over the Range Microwave</b>	<b>10</b>
<b>Island</b>	<b>11</b>
<b>Downdraft</b>	<b>12</b>
<b>Accessory specific assembly</b>	
<b>Magnetic Installation</b>	<b>13</b>
<b>Wall Mount</b>	<b>14</b>
<b>Freestanding</b>	<b>16</b>
<b>Cooksy App</b>	
<b>App Configuration</b>	<b>20</b>
<b>Setup Wizard</b>	<b>21</b>
<b>Calibrate</b>	<b>22</b>
<b>Quick Start Guide</b>	<b>23</b>
<b>Ready to Cook</b>	<b>24</b>
<b>Cooksy LED Indicator</b>	<b>26</b>

QR Code Instructions

**Watch the video**

Before you start, watch our installation video at  
<https://bit.ly/CS4help>  
Scan QR Code to see install video.



## CONTENT OF BOX

Verify installation options and check requirements



**Cooksy  
or  
Cooksy Pro**



**Antenna**

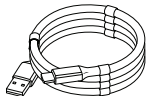

**Magnetic  
Power Cord**



**USB Power  
Adapter**

\* Note: Only use the USB Power Adapter that comes in the box.  
Do not use your own adapter.

## ACCESSORIES

If you have not ordered accessories for required Installation method, check page 3 for details and order at: [Cooksy.com](http://Cooksy.com)

A



**Magnetic**

No accessory needed

Cooksy has integrated magnets that allow for easy magnetic attach installation

B

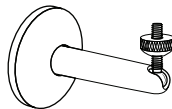

**Wall Mount**

For non-magnetic surfaces and optionally for Over the Range Microwaves and Wall Hoods

C

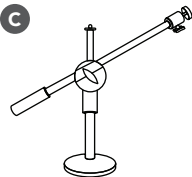

**Freestanding**

For Downdraft or optionally for Islands

Verify installation options and check requirements.  
Make sure you have chosen the right installation and accessory option for your kitchen variations.

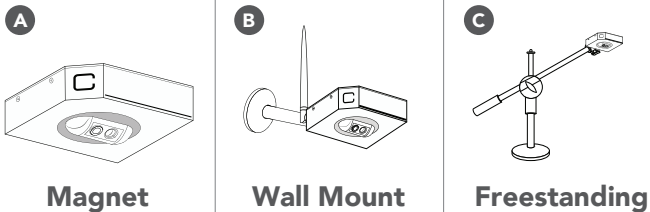

### Options

Options depend on ventilation setup and surface material.  
Preferred method for options **1** - **4** Magnetic Installation.

### Important General Requirements

#### Note:

Verify if hood surface works with magnets (for Options **1** - **4**)

Power outlet within 6 feet of the desired installation area.

Min 20 inches above Cooking surface required.

Install Cooksy off-center and out of direct line of heat.

For the Wall Mount installation option **B**, the screw attachment method is strongly suggested. 3M possible but not recommended.



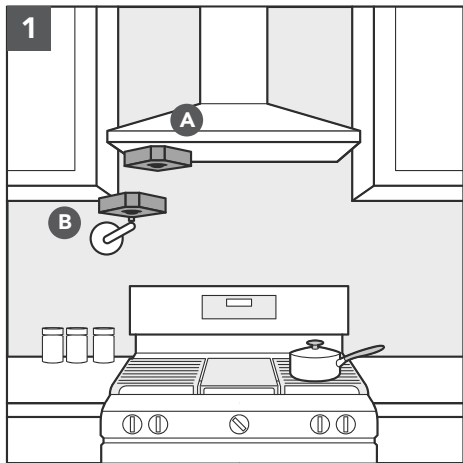

## Wall

Install Method **A** or **B**  
Off-Center

08

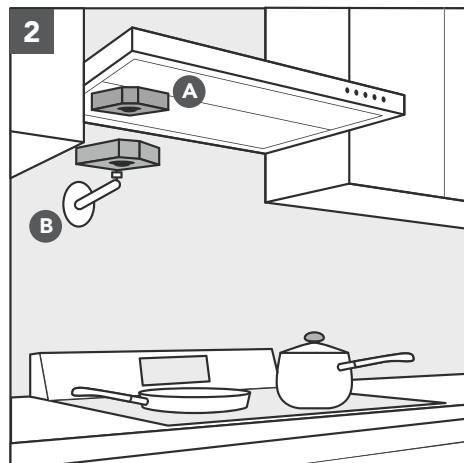

## Inset or Pullout

Install Method **A** or **B**  
Off-Center

09

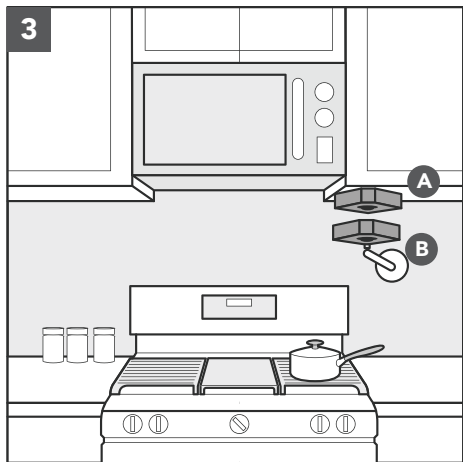

### Over the Range Microwave

Install Method **A** or **B**  
Off-Center

10

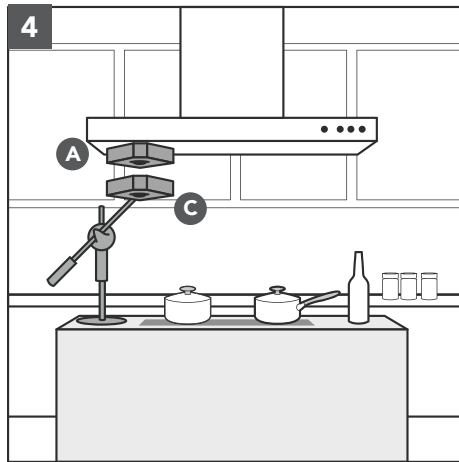

### Island

Off-Center  
Install Method **A** or  
Option **C** if non-magnetic

11

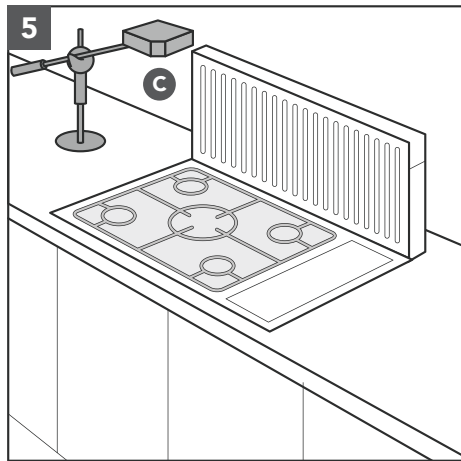

## Downdraft

Install Method **C**

For Install Method **B** and **C**  
Install method **A** needs no assembly

**A**



**Magnet**

**B**

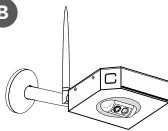

**Wall Mount**

**C**

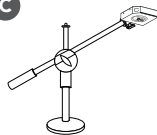

**Freestanding**

**A**

**Magnetic Installation**

- 1** Locate recommended install position (page 06-12).
- 2** Attach Antenna.
- 3** Attached Power Cable to Cooksy.
- 4** Route cable and connect to USB power adapter.

Install Cooksy off-center and out of direct line of heat.

**2**



**3**



**4**



**B Wall Mount**

Note: Clean Area with soapy water, rinse and dry

**Assembly**

- 1** Insert the tube core onto the center of the bottom base (the end with C angle faces outward).
- 2** Put the pivot ball into the bracket rod from the round end.
- 3** Cover the tube core with the bracket rod.
- 4** Pass through the bracket rod via the round hole of base cover, then rotate to tighten them.
- 5** Screw the metal nut onto the pivot ball tightly.

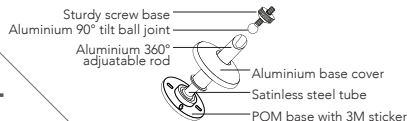
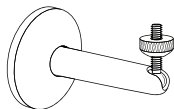
**Box Content****Assembled****B Wall Mount**

Assemble Wall mount Kit following instructions on page 14

Note: Screws are required

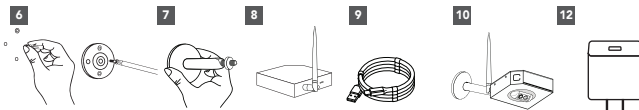
**Wall Installation**

- 6** Fix the bottom base to the wall via the included screws
- 7** Secure by tightening ring.
- 8** Attach Antenna.
- 9** Attached Power Cable to Cooksy
- 10** Fix the Cooksy on the mount via its female receiver in the back and the pivot ball.
- 11** Screw the plastic wheel to secure Cooksy.
- 12** Route cable and connect to USB power adapter.

**IMPORTANT**

3M adhesive included to support screw installation.  
Do not install without screws.

Warning: Relying on adhesive only is not covered by the manufacture warranty.

**C Freestanding**

Assemble Freestanding mount Kit following instructions.  
Position stand left or right of desired cooking surface

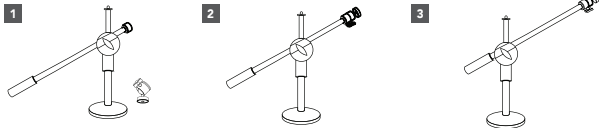
**Assembly**

- 1** Take the arm assembly and insert the large threaded end into the base. Screw the arm assembly in fully until tight.
- 2** Attach the swivel mount to the end of the arm assembly. Screw in the swivel mount until tight.
- 3** Adjust the arm by loosening the large arm nob, rotating the arm, and tightening the arm nob.

Box Content

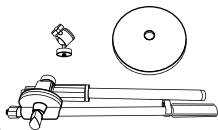

Assembled

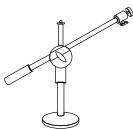

16

**C Freestanding**

Assemble Freestanding mount Kit following instructions on page 16

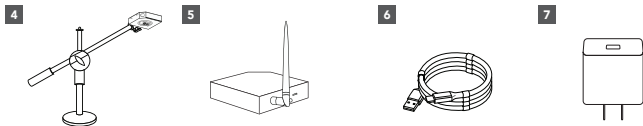
**Freestanding Installation**

- 4** Attach the Cooksy to the swivel mount and tighten the plastic nut.
- 5** Attach Antenna.
- 6** Attached Power Cable.
- 7** Route cable and connect to USB power adapter.
- 8** Position stand left or right of desired cooking surface.

17

## Download the Cooksy App

You'll use it to set up and control your Cooksy

At Startup: Swiping Blue LED Indicator



Already have a Cooksy?  
Open the Cooksy app and follow setup  
wizard to add new sensor

## App Configuration

At Cooksy Sensor Startup you will see a Swiping Blue LED Indicator which means Cooksy is ready to be configured

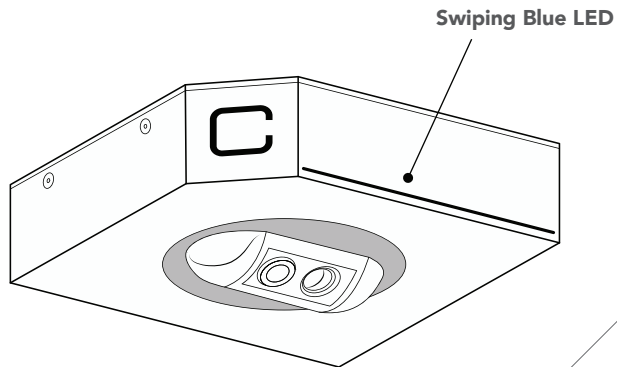

## App Configuration

Open the app to configure Cooksy on your Wi-Fi network

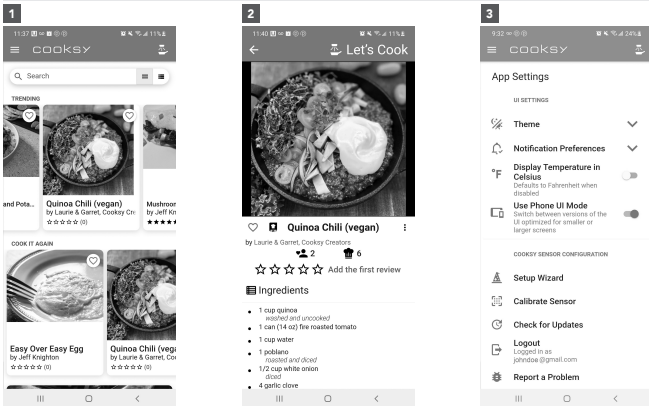

- 1 On the Top left, press the settings icon to open the menu.
- 2 Press the gear icon on the top center to open the App Setting menu.
- 3 Press the Setup Wizard button.

## Setup Wizard

Connect your Cooksy Sensor

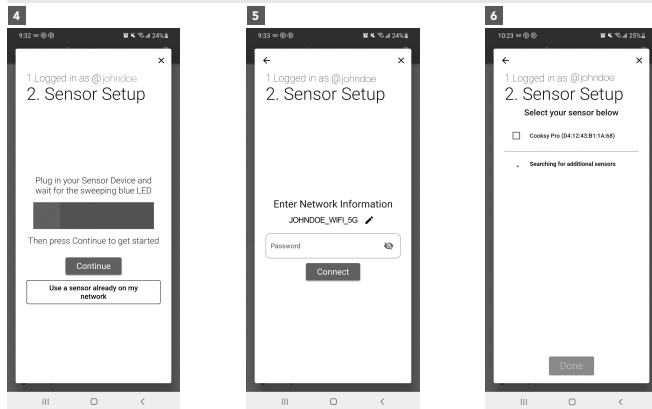

- 4 Sensor Setup Screen: Press continue
- 5 Choose network, enter Wi-Fi password and connect. White blinking light means its connecting. This will take a few moments
- 6 Once it's connected, it will turn green and Cooksy will show on app. Click the checkbox and then click Done.

## Calibrate

For first time setup, calibrate your Cooksy  
Cooksy calibrates best with non reflective pan surfaces

1

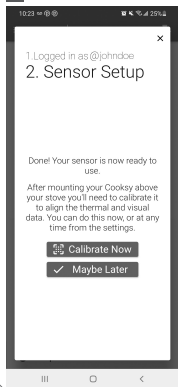

2

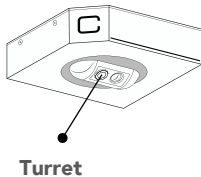

3

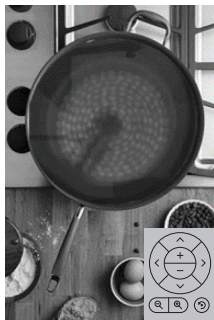

- 1 Place Pan on desired Cooking Surface and apply heat.
- 2 Adjust turret or mount, until thermal circle is centered.
- 3 Use adjust buttons to zoom-in and center the thermo circle.

## Quick Start Guide



## Ready to Cook

Find recipes in the App, gather the ingredients and start cooking. Follow the chef as they cook instead of following "a recipe".

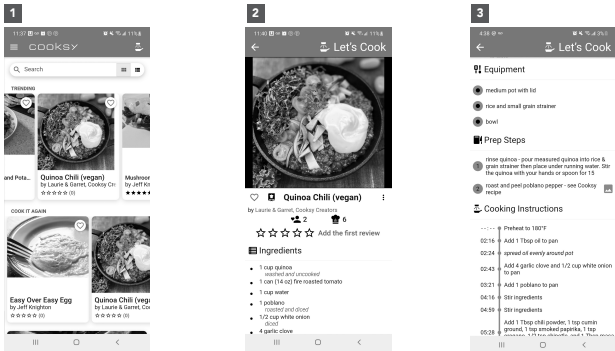

- 1 Choose recipe on App.
- 2 Watch the 30 seconds preview video.
- 3 Gather ingredients, view the equipment list/prep steps and preview the minute-by-minute cooking Instruction guide.

## Pro Tip

Use Cooksy to test your Pans.

The right cookware matters more than the heat source. Tap on the pan on your screen to set heat pins so you can identify your pans with best heat distribution.

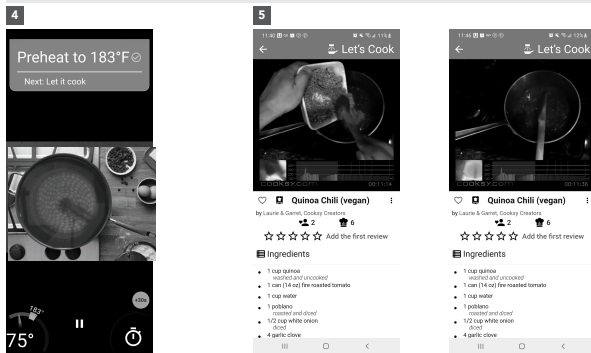

- 4 Press the Let's Cook Icon and preheat your cookware as instructed.
- 5 Follow the cooking instructions and re-create the recipe just like the chef intended it, and you end up with the same great food that they did.

## Cooksy LED Indicator

The LED indicator gives you visual feedback on connection, status, safety and interaction



<b>Light Blue</b>	Powering On and not ready.
<b>Swiping Blue</b>	Ready to be configured.
<b>Solid Green</b>	Connected to your Wi-Fi and ready to cook.
<b>Pulsing Green</b>	Firmware update. When done it restarts. Do not power off
<b>Cylon Green</b>	Trying to connect to Wi-Fi at startup. If for more than 10 seconds, then is out of range. Ensure antenna is attached, otherwise move Cooksy closer to router.
<b>Light Purple</b>	App is actively connected to Cooksy.
<b>Railroad crossing Red</b>	Warning, too Hot. Ensure its mounted correctly at 20" away out of direct line of heat.
<b>Bouncing Red</b>	Low voltage. Please check connection and ensure power brick is the official Cooksy power brick or a QC 3.0 USB power brick.
<b>Green progress bar</b>	Cooksy is uploading a recipe. See the mobile app for status.
<b>Purple Record mode</b>	Purple Record mode: When you are recording a recipe.

## Need Help?

For help and troubleshooting contact us at:

Email: [support@cooksy.com](mailto:support@cooksy.com) Phone: +1 (856) 924-6695

- 1) Read these instructions
- 2) Keep these instructions
- 3) Heed all warnings
- 4) Follow all instructions
- 5) Do not use this apparatus near water
- 6) Clean only with soft damp cloth. Household cleaners or solvents can damage the finish
- 7) Do not block any ventilation openings
- 8) Install in accordance with the manufacturer's instructions with a minimum of 20" distance between Cooksy and the cooking surface and a off-centered installation out of the direct line of heat.
- 9) Do not install on, near or against any heat source
- 10) Protect the power cable from being walked on or pinched, submerged or close to liquids, close to heat, particularly at plugs, convenience receptacles, and the point where they exit from the apparatus.
- 11) Only use attachments/accessories specified by the manufacturer
- 12) Unplug this apparatus during lightning storms or when unused for long periods of times.
- 13) Refer all servicing to Cooksy qualified personnel. Servicing is required when the apparatus has been damaged in any way, such as power supply cable or plug is damaged, liquid has been spilled or objects have fallen into the apparatus, the apparatus has been exposed to rain or moisture, does not operate normally, or has been dropped.
- 14) The Mains plug should be readily available to disconnect the equipment.
- 15) **WARNING:** To reduce the risk of fire or electric shock, do not expose this apparatus to rain or moisture.
- 16) Do not expose apparatus to dripping or splashing and do not place objects filled with liquids, such as vases on the apparatus

# COOKSY®

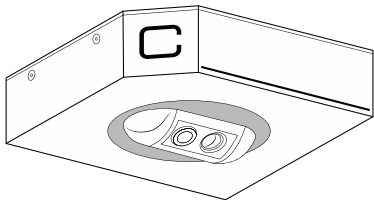

@2022 Cooksy Corporation. All rights reserved  
Cooksy and all other Cooksy product names and slogans  
are trademarks or registered trademarks of Cooksy, Inc

Use of the Works with Apple or Android badge means  
that app has been designed for Apple or Android App  
Stores, meeting their requirements to be on the App  
Stores.